

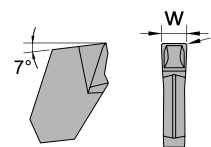

SGIH Parting Tools (Depth < 40mm)

Insert Specifications

Insert	Dimensions (mm)	
	w	r
TGTN0220	2.2	0.2
TGTN0310	3.1	0.2
TGTN0410	4.1	0.25



Insert Order Code

Inserts	Order No.	Designation	Working Material					
			P	M	K	N	S	H
	ITGTN022032HX	TGTN0220-CX32HX	●	●	●		○	○
	ITGTN022033TX	TGTN0220-CX33TX	●	●	●		●	●
	ITGTN022043TX	TGTN0220-CX43TX	●	●	●		●	
	ITGTN031032HX	TGTN0310-CX32HX	●	●	●		○	○
	ITGTN031033TX	TGTN0310-CX33TX	●	●	●		●	●
	ITGTN031043TX	TGTN0310-CX43TX	●	●	●		●	
	ITGTN041032HX	TGTN0410-CX32HX	●	●	●		○	○
	ITGTN041033TX	TGTN0410-CX33TX	●	●	●		●	●
ITGTN041043TX	TGTN0410-CX43TX	●	●	●		●		

* CX32HX, CX33TX grade for General cutting.
CX43TX grade for Interrupted cutting.

Recommended Cutting Conditions

Working Material	Vc (m/min)	Parting off, fr (mm/rev)		
		Cutting Width (w)		
		2	3	4
Carbon Steel / Alloy Steel	80 ~ 200	0.02 ~ 0.14	0.03 ~ 0.21	0.04 ~ 0.28
Stainless Steel	60 ~ 140	0.02 ~ 0.10	0.03 ~ 0.15	0.04 ~ 0.20
Cast Iron	80 ~ 200	0.04 ~ 0.14	0.06 ~ 0.21	0.08 ~ 0.28
High Temperature Alloy	50 ~ 100	0.02 ~ 0.06	0.03 ~ 0.09	0.04 ~ 0.12

SGIH Parting Tools (Depth < 40mm)

External Tool Holder Specifications

SGIH

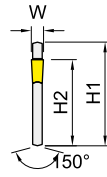
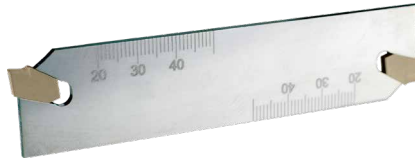
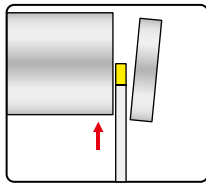

Insert Brand: Winstar, Iscar, ...

Order No.	Dimensions (mm)				Insert	Tool Block	Wrench
	H1	H2	L	W			
ISGIH26-2	26	21.4	110	2.2	TGTN0220	ISGTBU...26	IESG-1
ISGIH26-3	26	21.4	110	3.1	TGTN0310		
ISGIH26-4	26	21.4	110	4.1	TGTN0410		
ISGIH32-2	32	25	150	2.2	TGTN0220	ISGTBU...32	
ISGIH32-3	32	25	150	3.1	TGTN0310		
ISGIH32-4	32	25	150	4.1	TGTN0410		

SGTBU

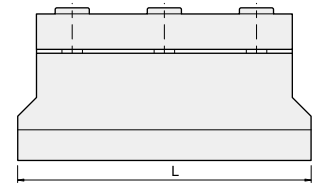
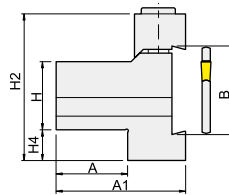

Order No.	Dimensions (mm)							Screw	Wrench	BLADE
	H	B	A	A1	L	H2	H4			
ISGTBU20-26	20	26	21	38	86	43	9	IHTM630	IPL50	ISGIH26-3
ISGTBU25-26	25	26	23	40	86	43	4			
ISGTBU20-32	20	32	21	40	110	50	13			ISGIH32-3
ISGTBU25-32	25	32	23	42	110	50	8			

SGTH

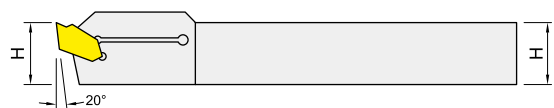
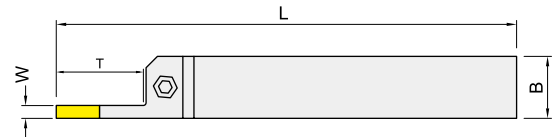
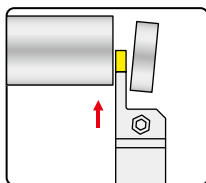

Insert Brand: Winstar, Iscar, ...

Order No.	Dimensions (mm)					Insert	Screw	Wrench
	H	B	L	W	T			
ISGTHR16162	16	16	110	2	16	TGTN0220	IHTM521	IPL40
ISGTHR20202	20	20	125	2	18			
ISGTHR20203	20	20	125	3	20	TGTN0310	IHTM625	IPL50
ISGTHR25253	25	25	150	3	25			
ISGTHR25254	25	25	150	4	30	TGTN0410	IHTM625	IPL50